

C.I.P.

7,62 x 25 Tokarev

Country of Origin: SU

TAB. IV

Date 90-04-04

Revision 06-09-19

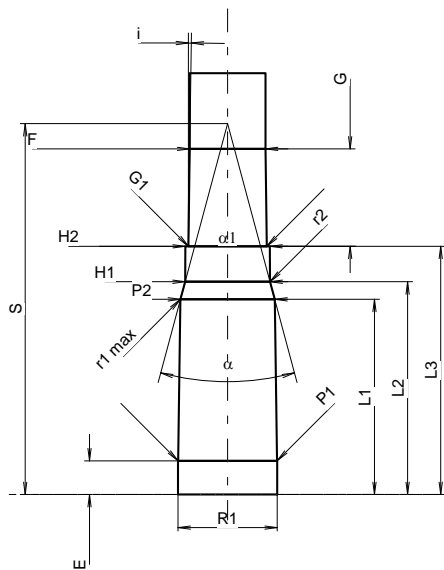
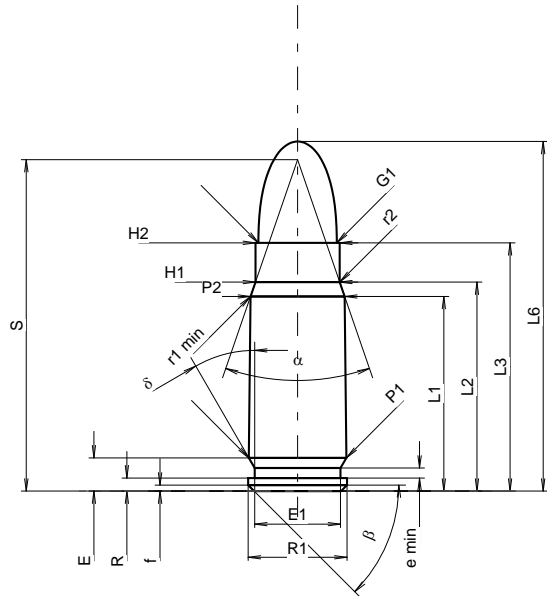

Scale 1.31:1

CARTRIDGE MAXI

Lengths

L1 1)*	=	19.60	-0.20
L2 1)*	=	21.04	-0.20
L3 1)	=	25.00	
L4	=		
L5	=		
L6	=	35.20	

Case Head

R	=	1.32	
R1	=	9.95	
R3	=		
E	=	3.34	
E1	=	8.65	
e min	=	1.00	
delta	=	30°	
f	=	0.60	
beta	=	45°	

Powder Chamber

P1	=	9.83	
P2 1)*	=	9.48	-0.20

Junction Cone

alpha	=	38°	
S	=	33.37	
r1 min	=	0.50	
r2	=	2.00	

Collar

H1 *	=	8.49	
H2 1)	=	8.49	

Projectile

G1 1)	=	7.90	
G2	=		
F	=		
L3+G 1)	=	34.80	

Pressures (Energies)

Method Transducer

Pmax	=	2500 bar	
PK	=	2875 bar	
PE	=	3250 bar	
M	=	17.50	

Miscellaneous Dimensions

Fe 1)3)	=	0.20	
delta L	=		

CHAMBER MINI

Lengths

L1 *	=	19.65	
L2 *	=	21.42	
L3 1)	=	25.00	

Breech

R	=	1.40	
R1	=	10.00	
R2	=		
R3	=		
r	=		

Powder Chamber

E	=	3.40	
P1 1)	=	9.95	
P2 *	=	9.50	

Junction Cone

alpha 1)	=	30°02'38"	
S	=	37.35	
r1 max	=	0.50	
r2	=	1.00	

Collar

H1 *	=	8.55	
H2 1)	=	8.50	

Commencement of Rifling

G1 1)*	=	7.90	
G 1)*	=	9.80	
alpha1	=	180°	
h	=		
s	=		
i 1)	=	0°49'6"	
w	=		

Barrel

F 1)*	=	7.62	
Z 1)	=	7.92	

Grooves

b	=	3.81	
N	=	4	
u	=	240.00	
Q	=	47.99	mm ²

Notes: 1) Check for safety reasons
3) Headspace on Shoulder
* Basic dimensions

Dimensions in << mm >>
Dimensions and Tolerances for Proof Barrels
see Appendix CR 1.